

# 32" CHANNEL DRAIN ANTI-ENTRAPMENT SUCTION OUTLET COVER AND PVC THREE-PORT MANUFACTURED SUMP



**VGB CERTIFIED SPECIFICATIONS**

**Floor Flow Rating**  
236 GPM at 3.4 fps

**Wall Flow Rating**  
136 GPM at 1.9 fps

**Sump Depth**  
*Use sump included*

**Open Area**  
22.6 in<sup>2</sup>

## FEATURES

All components meet or exceed ANSI/APSP 16-2011 and NSF/ANSI 50-2009a national standards and ASTM G154 UV testing exposure

Three ports: bottom 2½" OD, 2" ID S/S; inside 2" threaded FPT; two 2" threaded plugs included

Strong PVC sump does not require transitional glue

Designed for use with 2" hydrostatic relief valve part #HVxxx (see page 103)

Disposable plastic pre-gunite/plaster insert keeps debris out and retains sump shape during construction

#316 stainless steel screws

Manufactured from superior UV-resistant engineered polymers

Online product support including downloadable CAD files, General Certificate of Conformity, third-party certificate, installation instructions and more

Replace drain cover every five years from the date of installation

4 per case

U.S. patent 20140157510

## Unblockable!

**NEW** Improved water stop and sump design



**NEW** Water Stop and Textured Sump

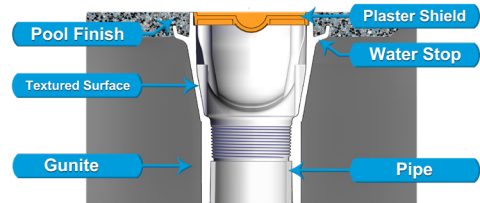

With sump (concrete pools)  
Part # 32CDAVxxx

## STANDARD COLORS

- 32CDAV101 – White
- 32CDAV102 – Black
- 32CDAV103 – Light Gray
- 32CDAV105 – Dark Gray

Also available as sump only,  
p/n 32CDPxxx  
4 per case

Also available cover only without  
sump/frame, p/n 32CDVNFxxx  
20 per case

**VGB 2008 Compliant**

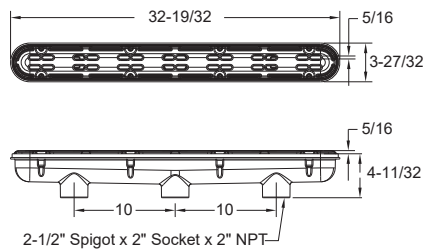

2-1/2" Spigot x 2" Socket x 2" NPT

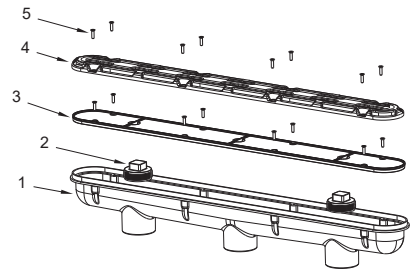

1. 32" Three-Port PVC Sump
2. 2" Tapered Threaded Pipe Plug, Qty 2
3. 32" Channel Drain Plaster Shield
4. 32" Channel Drain Anti-Entrapment Cover
5. 10 x 3/4" Flat Head Phillips, 316 SS, Qty 16

P 877-768-2717 F 877-276-POOL Outside the US: P +1-949-336-1940 F +1-949-336-1940  
info@aquastarpoolproducts.com www.aquastarpoolproducts.com